



# JOY & LYNCH CHRISTIAN THEATRE TECHNICAL SPECIFICATIONS

UPDATED 7/14/2020





## TABLE OF CONTENTS

TECHNICAL AND OPERATIONS STAFF CONTACTS	3
ARTIST QUICK INFO	4
SEATING CAPACITY	5
LOCATION	6
LOADING DOCK	7
TECHNICAL SPECIFICATIONS	8
SOUND AND COMMUNICATIONS SYSTEM	9
VIDEO AND PROJECTION SYSTEM	10
SUPPORT SPACES	11
LOCAL FACT SHEET	12
RESTAURANTS	15
DIRECTIONS	20



## TECHNICAL AND OPERATIONS STAFF CONTACTS

### CHIEF OPERATIONS OFFICER

Tabitha Abbott

Email: [tabbott@academycenter.org](mailto:tabbott@academycenter.org)

Office: (434) 528-3256 x115

### DIRECTOR OF PROGRAMMING

Brittany Griffith

Email: [bgriffith@academycenter.org](mailto:bgriffith@academycenter.org)

Cell: (727) 430-0501

Office: (434) 528-3256 x114

### PRODUCTION MANAGER

Michael Chagnon

Email: [mchagnon@academycenter.org](mailto:mchagnon@academycenter.org)

Office: (434) 528-3256 x320

### TECHNICAL DIRECTOR

Emily Parker

Email: [eparker@academycenter.org](mailto:eparker@academycenter.org)

Office: (434) 528-3256 x310

### BOX OFFICE MANAGER

Guy Mavinga

Email: [gmavinga@academycenter.org](mailto:gmavinga@academycenter.org)

Office: (434) 528-3256 x300



## ARTIST QUICK INFO

### Wifi:

Network: ACOA-Guests  
Password: AcademyGuest

### Mailing Address:

If you need to mail anything to the venue ahead of your event, please use the address below and note the attention to the venue contact you wish to receive the mail.

Academy Center of the Arts  
600 Main Street, Lynchburg, VA 24504

### Venue Address:

Joy & Lynch Christian Warehouse Theatre  
519 Commerce Street, Lynchburg, VA 24504

### Hours of Operation:

Admin Offices  
Box Office

M-F, 9AM – 5PM  
M-TH, 10AM – 4PM, F 12PM – 8PM, SAT 12PM – 4PM  
plus one hour before all performances





## SEATING CAPACITY

STADIUM RISERS	272
STADIUM RISERS PLUS ¾ THRUST FOLDING CHAIR SET UP	327
STADIUM RISERS PLUS FOUR ROWS OF FOLDING CHAIRS	372
ROUND TABLES SEATING 8 PERSONS	300
STANDING ROOM	743





## LOCATION

The Warehouse Theatre is located at 519 Commerce Street, at the corner of Fifth and Commerce, in Downtown Lynchburg, Virginia, just off of US-29 S, Exit 1A.

The public entrance to the Warehouse Theatre can be found under the awning, located to the right upon arrival in the parking area.

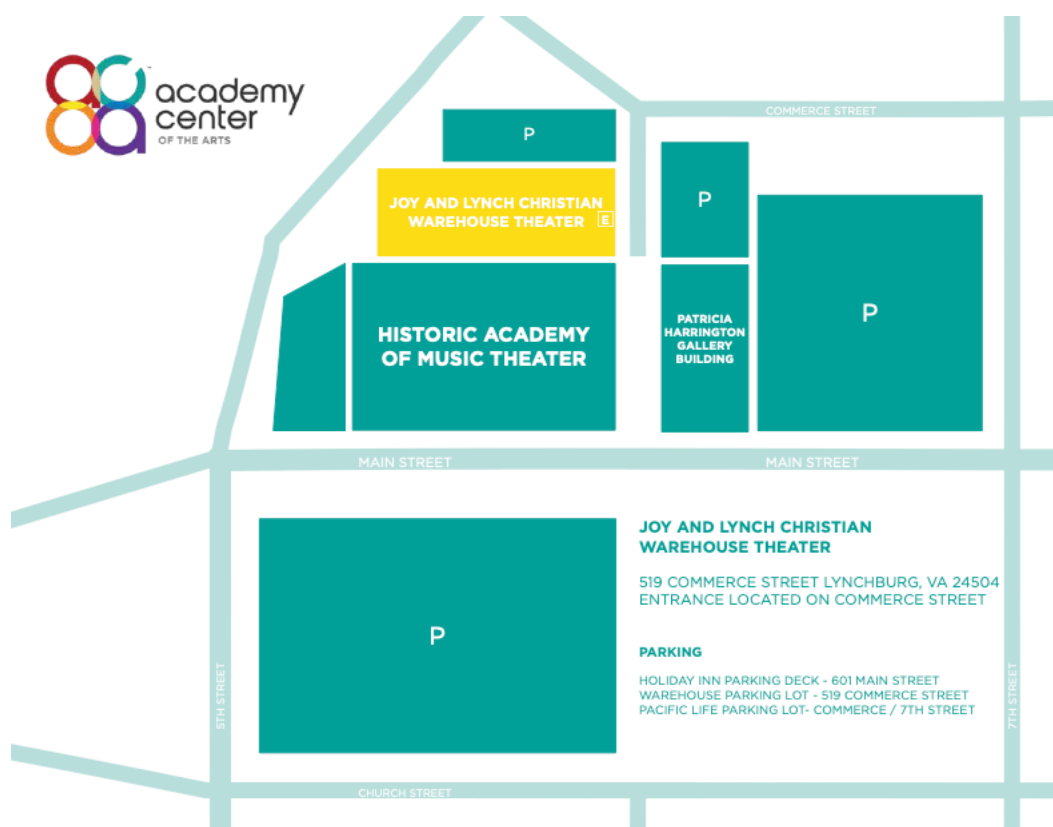



## LOADING DOCK

Loading dock can accommodate one (1) vehicle at a time. One (1) Double doors 7'6" wide x 9' high lead from loading dock, directly onto the Warehouse Theatre floor.

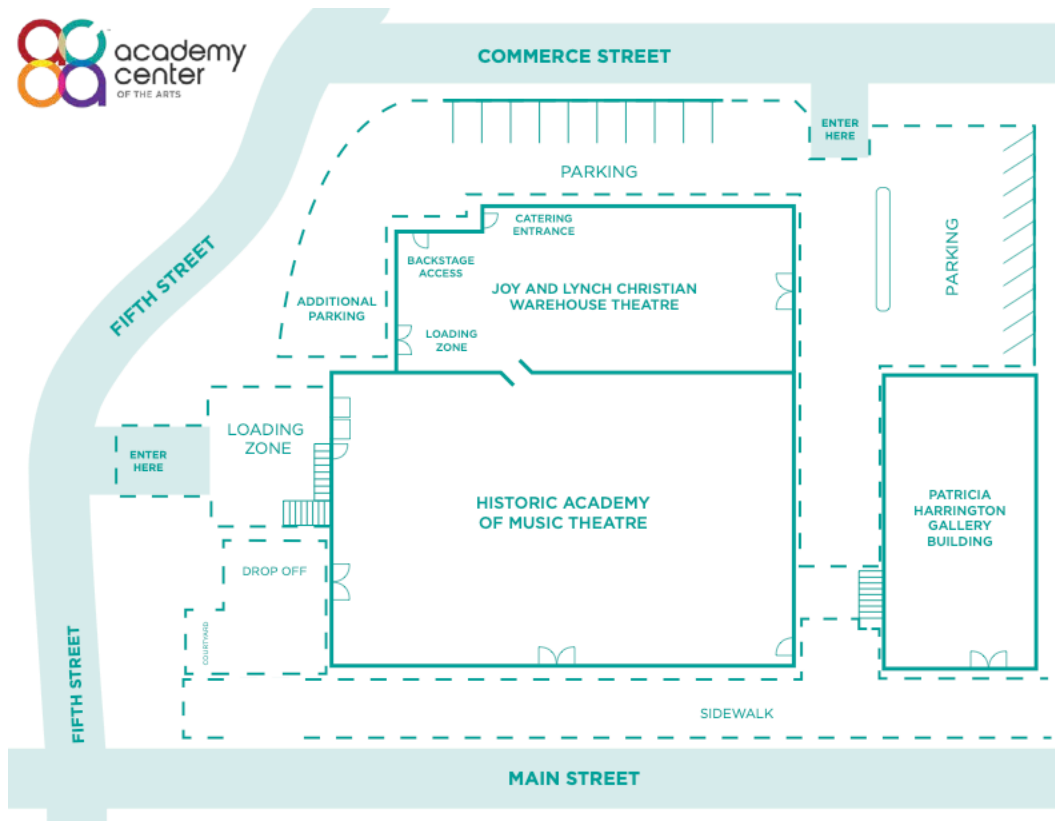



## TECHNICAL SPECIFICATIONS

### Dimensions:

73' 2 ½" x 71' 8 ½"

### Floor Construction:

Sprung hardwood flooring, measuring 73' 2 ½" x 71' 8 ½".

### Drapery:

The Warehouse Theatre is surrounded in blue curtains on a tracking system. Six (6) black legs are also available (10' x 15' 10").

### Rigging:

Black box lighting grid (7' by 7').

### Power:

- 400A company switch
- Technical grounded outlet network along perimeter of the Warehouse Theatre
- Standard 110V power outlets around perimeter of the Warehouse Theatre

### Sound Power:

There is isolated ground sound power throughout the facility. IG convenience outlets are orange and marked with a triangle. Equipment tying into the house sound system must get power from these outlets to avoid a ground loop.





## LIGHTING & PROJECTIONS SYSTEM

### Installed Lighting & Projection Systems:

- Christie HD 14K-M projector 13.5K lumens\*\*
- Draper motorized screen 15' 16:9
- HDMI inputs available on floor level of theater
- One flat screen TV located above entry doors in lobby available for looping presentation

*\*Please note that certain seats in the top two rows of seating risers will block the projectors path if anyone sits there.*

### Performance Lighting Fixtures (Refer to Rep Plot):

- (43) ETC Source 4 Ellipsoidal Body
  - (4) 19° Source 4 Barrel
  - (13) 26° Source 4 Barrel
  - (12) 36° Source 4 Barrel
  - (15) 50° Source 4 Barrel
- (19) Source 4 Jr (36°)
- (30) Source 4 Par
- (18) Altman Par
- (5) Altman Leko
- (3) Altman Fresnel
- (2) Power Spot 575
- (2) Follow spots

### Lighting Accessories:

- (28) 7.5" Barndoors
- (4) 10" Barndoors

### Performance Lighting Control:

- Console(s)
  - ETC Ion Xe
- Conventional Dimmers
  - (2) 48 Module (96 Ch) ETC Dimmer Racks
  - (1) 12 Module (24 Ch) ETC Dimmer Rack



## SOUND AND COMMUNICATION SYSTEM

### Mix Position:

House mix position is located in the control booth. The booth is on the upper level of the Warehouse and is behind sliding glass windows.

Depending on setup of event, a mix table may be placed anywhere on the Warehouse Theatre floor for a better mix position.

### Console:

- Presonus Studiolive III 32 channel console
- Presonus Studiolive 32R rack mixer/stagebox
- Meyer CP 10 parametric Equaliser

### Speakers:

- 2 ea Meyer UPA-1 active two way speakers
- 2 ea Presonus CDL 12 active two way array speakers
- 2 ea Presonus CDL 18 active subwoofers
- 5 ea Presonus ULT 15 active two way speaker enclosures

### Microphones:

Available to the Warehouse but shared with Historic Academy Theater:

- 16 ea Shure ULXD wireless bodypack wireless w/Countryman E6i ear sets  
-or-
- 8 ea Shure ULXD wireless handheld mics with SM58 capsules
- 5 ea SM58 vocal mics
- 2 ea Beta 58 vocal mics
- 6 ea ATM 350U clip on mics
- 5 ea AKG C1000S instrument mics
- 2 ea AT 4033 LDC mics
- 4 ea SM57 instrument mics
- 2 ea CBI DI boxes
- 2 ea Radial JDI stereo DI
- 2 ea Radial Pro AV1 DI box
- 1 lot mic stands, cables, clips, laptop interfaces

### Intercom System:

Clear Com system available throughout the facility in many configurations.



## SUPPORT SPACES

All support spaces are located on the same level as the Warehouse Theatre.

### Dressing Rooms:

**CHORAL DRESSING ROOMS (2):** Located through the backstage crossover. Complete with one (1) bathroom, one (1) sink, and one (1) shower each. A live audio feed from the Warehouse Theatre is available.

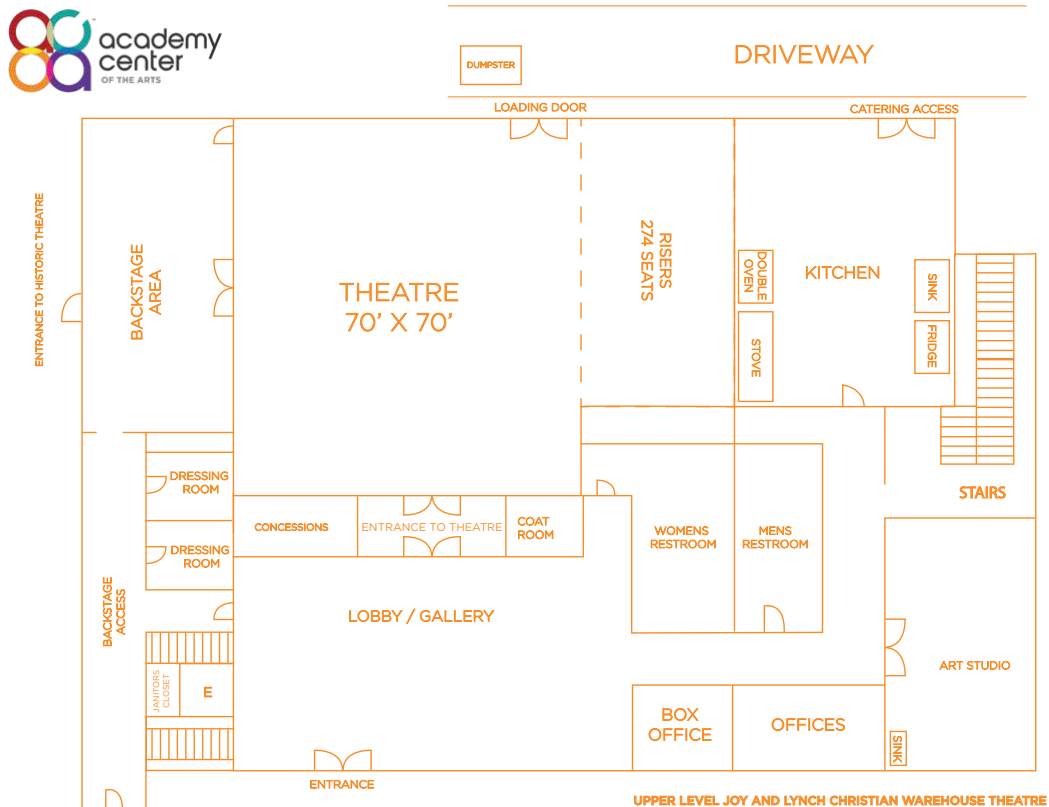



## LOCAL FACT SHEET

### TRANSPORTATION:

Uber and Lyft serve the City of Lynchburg

Allied Cab  
434-845-7039

Enterprise Rent-a-Car  
2415 Wards Road  
434-237-5656

### HEALTH SERVICES:

Centra Lynchburg General Hospital  
1901 Tate Springs Road  
434-200-3000

Virginia Baptist Hospital  
3300 Rivermont Avenue  
434-200-4000

### SAFETY SERVICES:

Lynchburg Police Department  
905 Court Street  
434-455-6050

Lynchburg Fire Department  
800 Madison Street  
434-455-6340

### PHARMACY:

Hill City Pharmacy  
800 Fifth Street  
434-845-2222  
Hours:  
M-Sun 10:00am-8:00pm



CVS  
4028 Wards Road  
434-239-7092  
Hours:  
M-F 9:00am-9:00pm  
Sat-Sun 9:00am-6:00pm

Walgreens  
2004 Wards Road  
434-832-0935  
Pharmacy Hours:  
M-F 9:00am-9:00pm  
Sat-Sun 9:00am-9:00pm

**GROCERY:**

Kroger  
4119 Boonsboro Road  
434-384-2415  
Hours:  
M-Sun. 6:00am-12:00am

Food Lion  
4925 Boonsboro Road  
434-384-0179  
Hours:  
M-Sun 7:00am-11:00pm

Walmart  
3900 Wards Road  
434-832-0304  
Open 24 hours

The Fresh Market  
3901 Old Forest Road Building A  
434-385-4202  
Hours:  
M-Sun 8:00am-9:00pm

Aldi  
2617 Lakeside Drive  
704-727-2755  
Hours:



M-Sun 9:00am-8:00pm

**LODGING:**

Holiday Inn Downtown  
601 Main Street  
(across the street from the venue)  
434-528-2500  
Check In: 3:00pm  
Check Out 12:00pm

The Virginian Hotel  
712 Church Street  
434-329-3200  
Check In: 4:00pm  
Check Out 11:00am

The Craddock Terrv Hotel  
1312 Commerce Street  
434-455-1500  
Check In: 4:00pm  
Check Out 12:00pm





## RESTAURANTS

Please see Production Manager for a menu book of establishments conveniently located to the Academy Center of the Arts.

### AMERICAN:

Market at Main  
Breakfast, burgers, salads, sandwiches, seafood, soups  
904 Main Street  
434-847-9040

Depot Grille  
Bar, steaks, seafood, sandwiches, salads, appetizers  
10 Ninth Street  
434-846-4464  
Hours:  
M-Th: 11:00am – 10:00pm  
F-Sat: 11:00am – 11:00pm  
Sun: 11:00am – 9:00pm

Jimmy's on the James  
American fine dining  
610 Commerce Street  
434-845-1116  
Hours:  
M-T 5:00pm-9:30pm  
W-Th 5:00pm-10:00pm  
F 5:00pm-10:00pm  
Sat 5:00pm-10:00pm

RA Bistro  
Bar, American cuisine including burgers and sandwiches, seafood, salads  
1344 Main Street  
434-845-1601  
Hours:  
M 11:00am-10:00pm  
T 11:00am-11:00pm  
W-Th 11:00am- 10:00pm  
F-Sat 11:00am- 12:00am  
Sun 10:00am- 10:00pm



#### Bootleggers

Bar, specialty burgers, appetizers, and salads

50 13th Street

434-333-4273

Hours:

M.-Thur. 4:00pm-10:00p

F 4:00pm-11:00pm

Sat 11:00am-11:00pm

Sun 11:00am-9:00pm

#### **BBQ:**

Fifth and Federal

Whiskey/beer bar, BBQ and southern style cuisine

801 Fifth Street

434-386-8113

Hours:

M 4:00pm-11:00pm

W-Th 11:00am-11:00pm

F-Sat 11:00am- 12:00am

Sun 11:00am- 9:00pm

#### **BRUNCH:**

My Dog Dukes

Breakfast, soups, salads, sandwiches, seafood

1007 Commerce Street

434-849-8868

Hours:

M.-Sun 7:00am-9:00pm

Market at Main

Breakfast, burgers, salads, sandwiches, seafood, soups

904 Main Street

434-847-9040

#### **CLEAN EATING:**

Crisp

Salad and juice bar

1124 Church Street

434-386-8998

Hours:

M-Sat 11:00am- 8:30pm



Sun 11:00am-4:00pm

### **COFFEE AND PASTRIES:**

Dublin 3 Coffeehouse

1001 Jefferson Street

434-439-4683

Hours:

M-Sat 6:30am- 11:00pm

Sun 1:00pm- 8:00pm

White Hart Cafe

1208 Main Street

434-207-5600

Hours:

M-Th. 7:00am- 10:00pm

F-Sat 7:00am-11:00pm Sun 10:30am-9:00pm

Cinn City Gourmet Buns & Beignets

1344 Main Street

434-215-3957

Hours:

Sun-Sat 7:00am- 9:00pm

Mama Crockett's Cider Donuts

500 Fifth Street

434-215-3275

Hours:

T-F 7:00am-9:00pm

Sat. 8:00am-9:00pm

Marigold

712 Church Street

434-616-4424

Hours:

Sun-Sat 6:30am-7:00pm

### **MEDITERRANEAN:**

Hot and Cold Cafe

Mediterranean/Indian cuisine, soups, salads

1206 Main Street

434-846-4976

Hours:



M 11:00am-8:00pm  
T 11:00am-3:00pm  
W- F 11:00am- 8:00pm  
Sat 11:00am-3:00pm

Tahini's Mediterranean Grill  
Mediterranean cuisine  
912 Main Street  
434-260-1465  
Hours:  
M-Sat 11:00am-8:00pm

#### **MEXICAN:**

El Jefe  
Tequila and taco bar  
1214 Commerce Street  
434-333-4317  
Hours:  
M-W 11:00am-10:00pm  
Th-Sat 11:00am-1:00am  
Sun 11:00am-10:00pm

#### **PIZZA:**

Waterstone Pizza  
Bar, pastas, salads, sandwiches, pizza  
1309 Jefferson Street  
434-455-1515  
Hours:  
M-Thur. 11:00am-10:00pm  
F-Sat 11:00am- 11:00pm  
Sun 11:00am-9:00pm

Benny Scarpetta's  
Pizza  
1019 Main Street  
434-528-5111  
Hours:  
Sun-Th 11:00am- 12:00am  
F-Sat 11:00am- 2:00am

Daughters and Son Pizza  
Sicilian style pizza



522 Fifth Street  
434-333-4244  
Hours:  
W-Sun 11:00am-9:00pm

#### **ROOFTOP VIEWS:**

Skyline  
Bar, steak, chicken, tapas platters, artisan flatbreads  
712 Church Street  
434-616-4425  
Hours:  
Sun-Th 4:30pm-11:00pm  
F-Sat 4:30pm-12:00am  
Brunch Sat-Sun 11:00am-2:00pm

#### **SEAFOOD:**

The Water Dog  
Bar, burgers, raw oysters, seafood, and appetizers  
1016 Jefferson Street  
434-333-4681  
Hours:  
M. 4:00pm- 11:00pm  
T 11:30am - 11:00pm  
W 11:30am - 11:00pm  
Th. 11:30am - 11:00pm  
F 11:30am - 1:00am  
Sat 11:30am - 1:00am  
Sun 11:30am- 11:00pm

#### **STEAKHOUSE:**

William & Henry Steakhouse  
Bar, steak, seafood  
712 Church Street  
434-616-4423  
Hours:  
M.-Sat 4:30pm-10:00pm



## DIRECTIONS

### **From 221:**

Follow 221 to Lakeside Dr. and continue on Lakeside Dr.  
Turn left onto Memorial Ave. and continue on Fifth St.  
Turn right onto Church St.  
Turn left onto Main St.  
Turn right onto Fifth St.  
Turn right onto Commerce St.  
The Warehouse Theatre is located on your right

### **From US-29 BUS (coming south):**

Follow US-29 BUS S to the VA-163 exit and continue across bridge into downtown Lynchburg  
Turn left onto Commerce St.  
The Warehouse Theatre is located on your right

### **From US-29 BUS (coming north):**

Follow US-29 BUSN N to exit 1A towards Downtown/Riverfront  
Turn right onto Main St.  
Turn right onto Fifth St.  
Turn right onto Commerce St.  
The Warehouse Theatre is located on your right

### **From US-460 E (coming north):**

Follow US-460 E to US-501 N/Candlers Mountain Road exit  
Merge right onto US-29 BUS N ramp  
Follow US-29 BUSN N to exit 1A towards Downtown/Riverfront  
Turn right onto Main St.  
Turn right onto Fifth St.  
Turn right onto Commerce St.  
The Warehouse Theatre is located on your right

### **From US-501 S:**

Follow US-501 S as it turns into US-29 BUS N  
Follow US-29 BUSN N to exit 1A towards Downtown/Riverfront  
Turn right onto Main St.  
Turn right onto Fifth St.  
Turn right onto Commerce St.  
The Warehouse Theatre is located on your right